

Attachment (A)

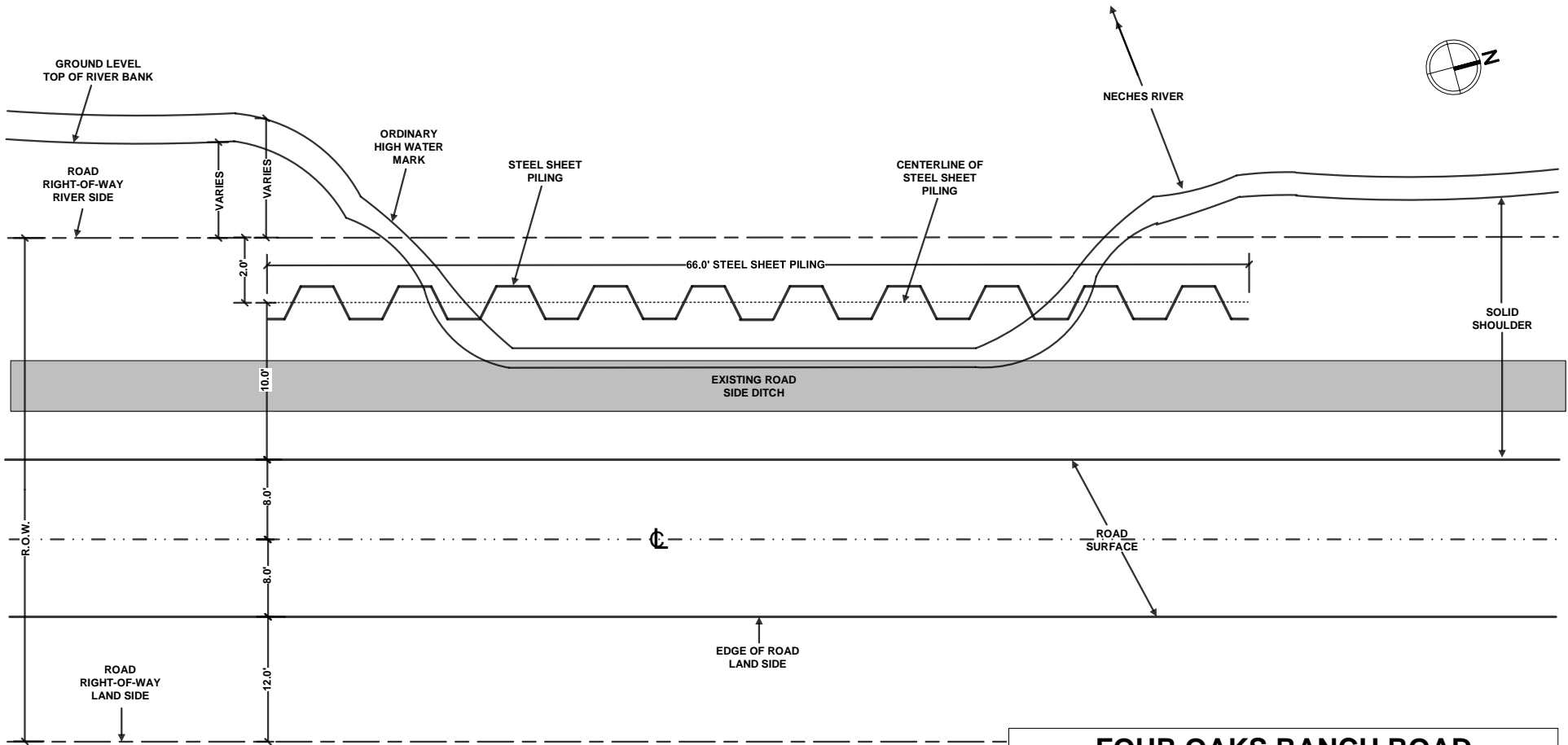

**NOTES:**

1. PZ-27 STEEL SHEET PILING, ITS EQUIVALENT OR OF A HIGHER QUALITY/GRADE 30.00 ft. LONG AND 66.00 ft. WIDE, TO BE PURCHASED AND INSTALLED BY CONTRACTOR.
2. TOP ELEVATION OF PILING TO BE SAME ELEVATION AS CENTERLINE OF ROADWAY.
3. ALL OTHER WORK TO BE DONE BY ORANGE COUNTY (ANCHORS, BACKFILL, ETC...)

**CONTACT INFORMATION**  
 ORANGE COUNTY ROAD & BRIDGE DEPT.  
 OFFICE: 409-882-7905

<b>FOUR OAKS RANCH ROAD</b>		
<b>HAZARD MITIGATION PROJECT</b>		
<b>SHEET PILE INSTALLATION, PLAN VIEW</b>		
<b>ROAD SHOULDER REPAIR DETAILS</b>		
SCALE: N.T.S.	APPROVED BY:  C. SLACUM	DRAWING #  <b>D-1.1</b>
DATE: 8-29-18		
DRAWN BY: T.G.		

Attachment (A)

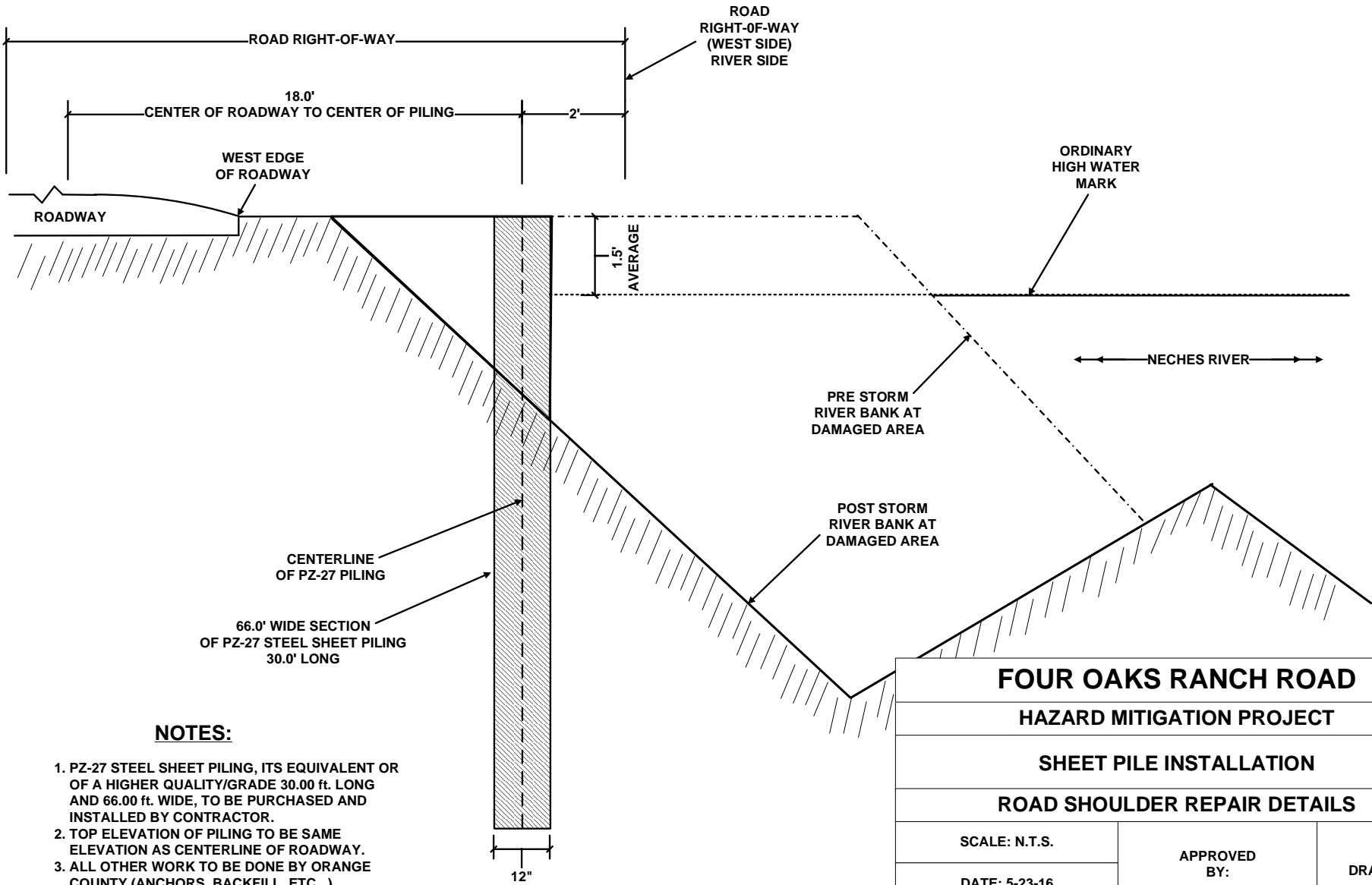

**NOTES:**

1. PZ-27 STEEL SHEET PILING, ITS EQUIVALENT OR OF A HIGHER QUALITY/GRADE 30.00 ft. LONG AND 66.00 ft. WIDE, TO BE PURCHASED AND INSTALLED BY CONTRACTOR.
2. TOP ELEVATION OF PILING TO BE SAME ELEVATION AS CENTERLINE OF ROADWAY.
3. ALL OTHER WORK TO BE DONE BY ORANGE COUNTY (ANCHORS, BACKFILL, ETC...)

**DETAIL  
"A"  
EXPANDED**

<b>FOUR OAKS RANCH ROAD</b>		
<b>HAZARD MITIGATION PROJECT</b>		
<b>SHEET PILE INSTALLATION</b>		
<b>ROAD SHOULDER REPAIR DETAILS</b>		
SCALE: N.T.S.	APPROVED BY:  C. SLACUM	DRAWING #  <b>D-1.2</b>
DATE: 5-23-16		
DRAWN BY: T.G.		